

GEM 4TH INTERNATIONAL SUSTAINABILITY CONCLAVE, EXPO & AWARDS 2021

30th November to 2nd December 2021 (Virtual)

&

3rd - 4th December 2021, India Habitat Centre, New Delhi*

“ For us, protection of environment is an article of faith. We have natural resources because our previous generations protected these resources. We must do the same for our future generations. ”



Mr. Vineet Agarwal
President, ASSOCHAM
& MD, Transport Corporation
of India Limited



Mr. Sumant Sinha
Sr. Vice President, ASSOCHAM
Chairman & MD
ReNew Power



Dr. Niranjana Hiranandani
Immediate Past President, ASSOCHAM
Co-Founder & Managing Director
Hiranandani Group of Companies



Mr. Rajan N Bandelkar
President, NAREDCO
Director, Unnathi Estate
(Raunak Group)



Ar. Habeeb Khan
President
Council Of Architecture
New Delhi



Mr. Deepak Sood
Secretary General
ASSOCHAM



Mr. Pankaj R. Dharkar
Chairman, ASSOCHAM Green
Building Council & President
Pankaj Dharkar & Associates

The Associated Chambers of Commerce and Industry of India



ASSOCHAM GEM Green Building Certification Program

ASSOCHAM, the century old organisation, executes the GEM Green Building Certification Program for the sustainable design and development of the buildings and related developments. The objective is to ensure future buildings move towards environment friendly methods of design, construction and operations.

ASSOCHAM awards GEM Green Building Certification Rating, to all GEM compliant buildings. GEM stands for Green and Eco-friendly Movement.

GEM is the first indigenous Green Building Certification Program of the nation that includes the concept of Sustainability, Energy and Water Efficiency, Fire and life safety, Indoor Air Quality, Daylight, Fresh Air, Human Comfort and UNSDG 2030 goals as parameters.

GEM is based on latest guidelines of BEE ECBC 2017 and NBC 2016.

GEM has made rapid stride since it's conception and has certified many new and existing prestigious Government and Private projects including residential, commercial, health care, warehouse, smart campuses, universities, schools, airports, and railway station buildings.

With 14 MoUs with leading organizations in building industry (such as NAREDCO, CSIR-NEERI, TERRE, IIA, ISHRAE, FSAI, ISLE, IAQA, ASHRAE etc), many Architects, MEP, Environment and Green consultants, 80+ MoUs with Educational Institutions, 9 state chapters, and more than 1500+ GEM Certified professional, ASSOCHAM GEM Green Building Certification stands out as an intent driven, cost effective, simple process oriented, indigenous Green Building Rating Program in India.

Profile of Participants

The International Conclave and Expo will be attended by 3500+ reputed National and International Architects, MEP, Environment and Sustainability Consultants including the prestigious delegates from Nepal, Srilanka, Bangladesh and Bhutan, MoHUA, MoEF&CC, MNRE, DST, NBCC, CPWD, BEE, CREDAI, NAREDCO, CSIR-NEERI, TERRE, IIA, ISHRAE, FSAI, ISLE, IAQA, ASHRAE and many more...

- Architects
- Civil/ Mechanical/ Electrical/ Plumbing Engineers
- Construction materials and equipment companies
- Contractors
- Educational Institutes
- Energy company strategists
- Energy majors/analysts
- Energy technology innovators
- Government and regulatory bodies
- Green Building Consultants
- HVAC Consultants
- Investment bankers
- Landscape architects
- Low carbon technology companies
- Non-governmental organisations
- Private Organizations
- Project Managers
- Real Estate developers and owners
- Renewable energy associations
- Specialist and financial consultants
- Students
- Town Planners
- Urban Designers
- Urban local bodies

Showcase your Products and Services



Special Technical Sessions

- Passive Design Strategies
- Impact of Ecology on Built Environment
- Passive HVAC Strategies and Indoor Air Quality
- Sustainability Across Nations
- Developing Codes for Sustainability in India
- Fire and Life Safety integration with Sustainable Buildings
- Outdoor Air Quality & Pollution Control
- Sustainable Lighting in Built Environment
- Sustainability Challenges in High Rise Building
- Integrating Landscape and Sustainability
- Waste Management
- Water Management

Benefits to the Partners

| DELIVERABLES | PRINCIPAL PARTNER | PLATINUM PARTNER | GOLD PARTNER | SILVER PARTNER | LUNCH PARTNER | KIT & LANYARD PARTNER |
|--|-----------------------|-----------------------|-----------------------|-----------------------|-----------------------|-----------------------|
| | INR Rs. 8,00,000/- | INR Rs. 6,00,000/- | INR Rs. 4,00,000/- | INR Rs. 3,00,000/- | INR Rs. 2,50,000/- | INR Rs. 2,00,000/- |
| Speaking slot during Inaugural Session | Yes | - | - | - | - | - |
| Speaking slot during Technical Sessions | Yes | Yes | Yes | Yes | Yes | - |
| Special Social Media Marketing | Yes | Yes | - | - | - | - |
| Space for Standees (Nos.) | 4 | 3 | 2 | 2 | 2 | 2 |
| Logo with hyperlink on Conclave Website | Yes | Yes | Yes | Yes | Yes | Yes |
| Ready to Occupy Stall | ✓ (9 sq.m) | ✓ (9 sq.m) | ✓ (9 sq.m) | ✓ (9 sq.m) | - | - |
| Company Corporate Film to be displayed during Breaks and Start of Sessions | 3 Min/ Each Break | 2 Min/ Each Break | 1 Min/ Each Break | - | - | - |
| Company Logos on acknowledgement standees | Yes | Yes | Yes | Yes | Yes | Yes |
| Visitor Registration page (Exclusive) | Yes | Yes | Yes | Yes | Yes | Yes |
| Promotion in Social Media Platforms | Yes | Yes | Yes | Yes | Yes | Yes |
| Platform for Networking | Yes | Yes | Yes | Yes | Yes | Yes |
| Sharing of List of Conclave Participants | Yes | Yes | Yes | Yes | Yes | - |
| Customised Webinar | 2 till Dec. 2021 | 2 till Dec. 2021 | 2 till Dec. 2021 | 1 till Dec. 2021 | - | - |
| Industry Specific Sustainability Training for the sales team | (15 Persons) | (15 Persons) | - | - | - | - |
| Company Logo on Stage Backdrop during Inaugural function & conferences | Yes | Yes | Yes | Yes | Yes | Yes |
| Promotional Materials of Company to be included in Delegate Kit | Yes | - | - | - | - | Yes |
| Delegate Passes | 3 | 2 | 2 | 2 | 2 | 2 |

Terms & Conditions for Participation as Sponsors/Exhibitors

- ⦿ Whilst every attempt will be made to ensure that all aspects of exhibition and sponsorship mentioned will take place as announced, the Organizer reserves the right to make changes if the situation requires.
- ⦿ The Organizer reserves the right of final decision regarding the allocation of exhibition stall.
- ⦿ The stalls will be booked on first-come-first-serve basis.
- ⦿ The basic stall size of 3 x 3 metres (9 sq. metres) stall rental includes 1 table, 2 chairs, 3 spotlights, 1 power point, 1 waste paper basket, fascia name.
- ⦿ The Organizer is not responsible for personal accidents and damage to the private property of exhibitors. Therefore, exhibitors may wish to make their own arrangements with respect to personal insurance.
- ⦿ Acceptance of sponsorship applications will be the sole discretion of the Organizer. The Organizer reserves the right to decline application based on any association, direct or indirect, that does not uphold the objectives of the convention without assigning any reason whatsoever.
- ⦿ All Govt. taxes will be charged extra and as per actual.
- ⦿ Payment terms:- Full advance payment

EXPO LAYOUT PLAN

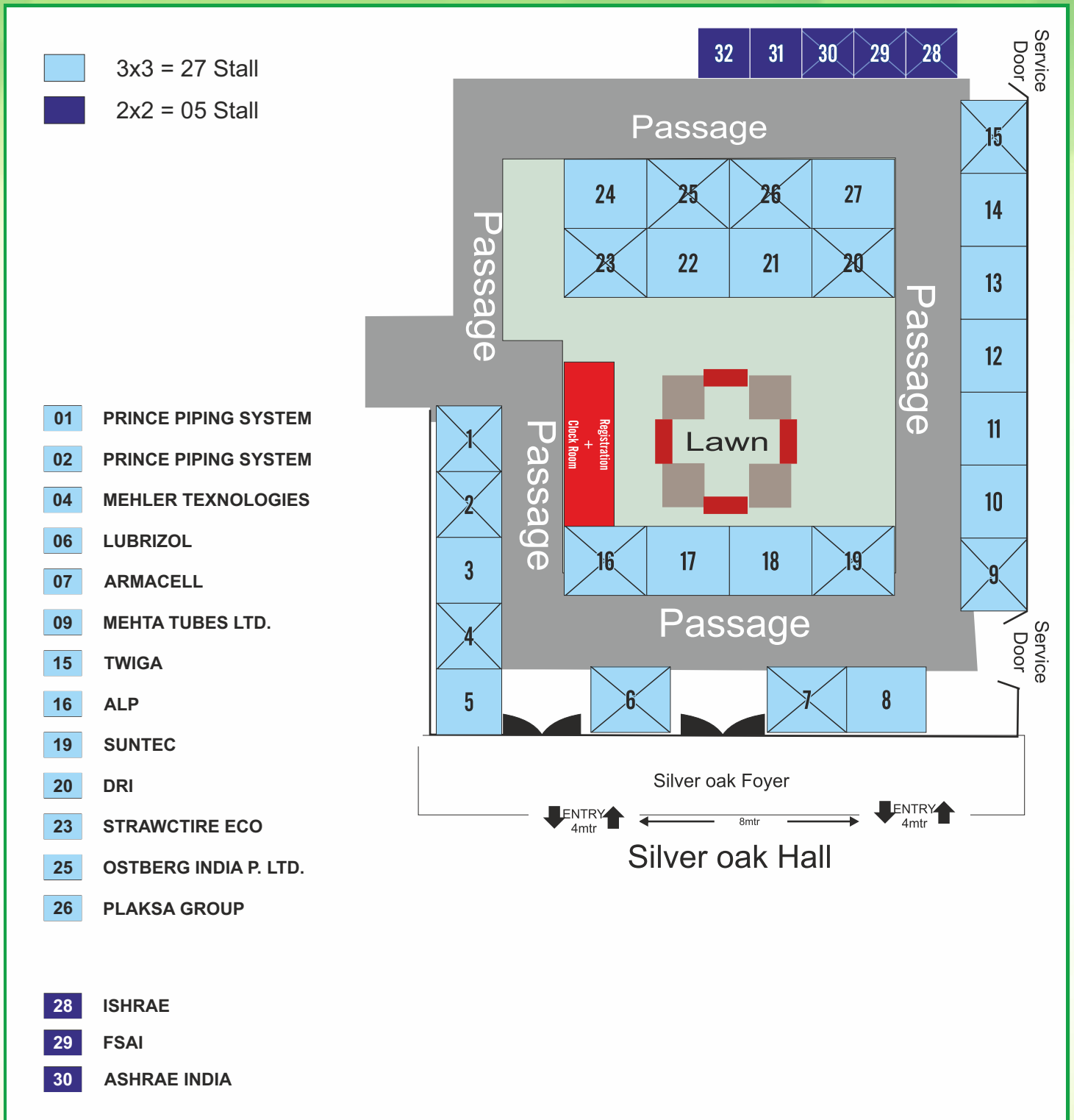

Alongside the convention, we are also organizing an exhibition for the building material and product manufacturers, traders, suppliers at the same venue.

Total No. of Stall – 32

Size per stall – a) 3 x 3 mtrs = 27

b) 2 x 2 mtrs = 05

Cost per Stall – Rs. 40,000/-plus 18% GST

Stall rental includes = 1 table, 2 chairs, 3 spotlights, 1 power point, 1 waste paper basket, fascia name

BENEFITS: Effective contacts with number of Architect, Green Building Consultants, MEP Consultants, Developers & Real Estate Professionals.

Great opportunity for business networking.

Eminent Speakers*



Ar. Surinder Bahga
Chairman, GEM Punjab Chapter & Principal Architect Saakaar Foundation



Ar. Tushar Sogani
Chairman, GEM Rajasthan Chapter & Managing Director Tushar Sogani Designs Pvt. Ltd.



Ar. Anand Tatu
Chairman, GEM Gujarat Chapter & Chairman M/s. Anand Tatu Architects



Ar. Anupam Mittal
Chairman, GEM UP Chapter & Principal Architect ARINEM Consultancy Services



Ar. Debatosh Sahu
Chairman, GEM West Bengal Chapter & Principal Architect and Partner, ESPACE



Ar. Leena Kumar
Chairperson, GEM Karnataka Chapter & Principal Architect and Partner, Kumar Consultants



Ar. Vilas Avachat Vasant
Chairman, GEM Maharashtra Chapter & Managing Director M/s. Vilas Avachat & Associates



Ar. Navin Sharma
Chairman, GEM Chhattisgarh Chapter & Principal Architect Navin Sharma & Associates



Ar. Soumyendu S Ray
Chairman, GEM Odisha Chapter & Director, School of Architecture and Planning, KIIT University



Ar. Sandeep K Jha
Chairman, ASSOCHAM GEM Jharkhand Chapter* Principal Architect, studio AXIS



Ar. Sudhir Balakrishnan
Chairman, ASSOCHAM GEM Kerala Chapter* Chief Architect, Architect's Consortium



Ar. Manu Malhotra
Chairman, GEM Green Healthcare Certification Rating & Director RSMS Architects Pvt. Ltd.



Ar. Gaurav Varmani
Chairman, GEM Green Warehouse Certification Rating & Founder Studio LINEDESIGN



Ar. Ravish Mehra
Chairman, GEM Green Interior Rating & Partner RMDK Architects



Ar. Charanjit Shah
Joint Chairman, GEM Institutional Collaborations and Trainings Committee & Chairman, Smart Habitat Foundation and Founder Principal, Creative Group



Dr. Rajendra Shende
Chairman, TERRE Policy Centre Former Director, UNEP



Mr. Amitabha Sur
National President ISHRAE



Mr. Suresh Menon
National President Fire & Security Association of India



Mr. Sameer Saxena
General Secretary GACS



Ar. Vijay Garg
Joint Chairman, GEM Institutional Collaborations and Trainings Committee & Managing Director Vastuki Consultants



Mr. Rajnish Aggarwal
Chairman, GEM Events and Expo Committee & Managing Partner Pankaj Dharkar & Associates



Mr. Dilip Kumbhat
President Indian Society of Lighting Engineers (ISLE)



Mr. Nihar Chheda
Vice President, Strategy Prince Pipes and Fittings Limited



Mr. Manish Jain
Sr. Manager, Market Development Strategy & Execution - South Asia Lubrizol Advanced Materials India P. Ltd.



Mr. Rahul Aeron
Assistant Vice President-Sales Desiccant Rotors International Pvt. Ltd. (DRI)



Mr. Ajay Popat
Chairman, ASSOCHAM Council on Water & President Ion Exchange (India) Ltd.



Ms. Shriti Pandey
Founder & CEO SEPL



Dr. Prakash Barjatia
Member, ASSOCHAM, GEM Green Building Council & GB Member & Director Education & Training, Indian Society of Lighting Engineers (ISLE)



Mr. Amit Sahu
Sales, Commercial Building Segment, GRUNDFOS Pumps India Pvt. Ltd.



Mr. Akash Yadav
Country Manager SAARC Countries KAN Group



Mr. Sandeep Narang
Chairman, GEM Committee for Students Activities & Sr. Consultant Sustainable Construction



Mr. Ashu Gupta
Chairman, GEM Projects Committee & Managing Partner Design2Occupancy Services LLP



Ar. Dinesh Bhagat
Co-Chairman GEM Punjab Chapter



Dr. Balkar Singh
Co-Chairman, GEM Punjab Chapter and Joint Director (Retd.), PEDA



Ar. Nischal Jain
Co-Chairman, GEM Rajasthan Chapter & Professor MNIT, Jaipur



Ar. Gaurav Agrawal
Co-Chairman, GEM Rajasthan Chapter & Principal Architect Gaurav Agrawal Design Studio



Ar. Lokendra Balasaria
Co-Chairman, GEM Gujarat Chapter & Architect & Urban Planner, LaSpazio



Ar. Anurag Bajpai
Co-Chairman, GEM UP Chapter & Director GreenTree Global



Ar. Abin Chaudhuri
Co-Chairman, GEM West Bengal Chapter & Founder Abin Design Studio



Ar. Bindi Saolapurkar
Co-Chairperson, GEM Karnataka Chapter & Founding Partner & Architect M/s. Saolapurkar & Associates



Ar. Roshni Udyavar Yehuda
Co-Chairperson, GEM Maharashtra Chapter & Director Roshni Udyavar and Associates



Ar. Raj Prajapati
Co-Chairman GEM Chhattisgarh Chapter & Principal Architect, Cubicles

Eminent Speakers*



Prof. Sangram Mohanty
Co-Chairman, GEM Odisha Chapter & Architect MEP/ Green Consultant



Mr. Richie Mittal
Executive Member, GEM Green Building Certification Council & Managing Director Overdrive Engineering Pvt. Ltd.



Mr. Vishal Kapoor
Executive Member, GEM Green Building Certification Council & Managing Director Meho - HCP Air Systems Pvt. Ltd.



Mr. Pinaki Dasgupta
Co-Chairman, GEM Global Collaborations and State Chapter Committee & General Manager C. P. Consultant Pvt. Ltd.



Mr. Sudhir Mathur
Secretary, GEM Rajasthan Chapter & MEP Consultant Shreshitha Consultants



Er. Dipen Mehta
Secretary, GEM Gujarat Chapter & Managing Director PCS Project Management Pvt. Ltd.



Mr. Kushagra Juneja
Co-Chairman, GEM Rating Programs & Managing Partner Design2Occupancy Services LLP



Prof. Sonia Gupta
Secretary, GEM West Bengal Chapter & Principal, Amity School of Architecture and Planning Amity University, Kolkata



Prof. Dr. Ajai Chandran C.K.
Secretary, GEM Karnataka Chapter & Principal SJB Institute of Technology



Ar. Rajeev Taishete
Secretary, GEM Maharashtra Chapter & Principal Architect Rajeev Taishete & Associates



Ms. Aditi Patel
Secretary, GEM Chhattisgarh Chapter & Director Adira Innovations



Mr. M. K. Iqbal
Secretary, GEM Odisha Chapter & Adjunct Professor KIIT School of Architecture



Mr. Money Khanna
Co-Chairman, GEM Events and Expo Committee & Executive Member GEM Punjab Chapter



Ar. Glory Srivastava
Program Chair, GEM UP Chapter & Principal Architect & Founder Buildgreen Design

Glimpses of Past ASSOCHAM & GEM Events



Glimpses of Virtual Event 2020

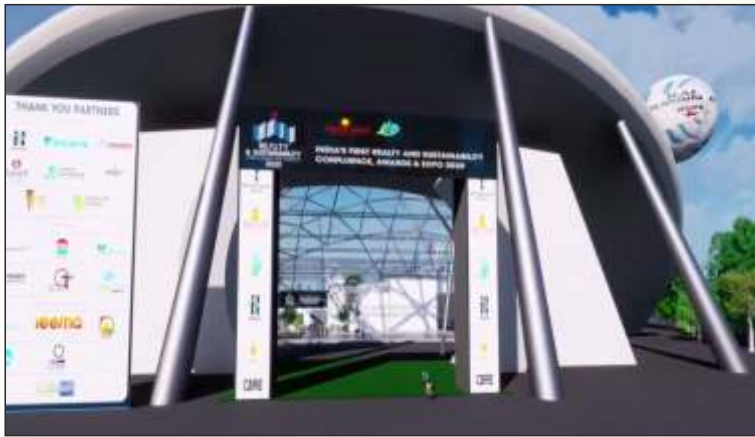



GEM is being continuously improved to align with United Nation SDG-2030. GEM is the first comprehensive rating system in the world, to recognize sustainability, rather than incorporating few components of it.

Prodigious recognition by India's Century old Apex Industry Chamber for the buildings.

Sustainable buildings cost extra INR 6-10 per sq. ft than compared to conventional buildings.

GEM is first indigenous program based upon ECBC 2017 and NBC 2016 and addresses fire and life safety.

It is an affordable certification program. GEM fee is up to 30% less than other programs.



Payback period is only 3-4 years.

Regular interaction between GEM and Project teams even post certification.

ASSOCHAM GEM Chapters

Mission 20 States and 5 Adjoining Countries

ASSOCHAM has a team of more than 2,000 Professionals, Architects and Designers across the nation who support designing various facilities GREEN.

In just three years, more than 8 million sqft has been GEM certified across India

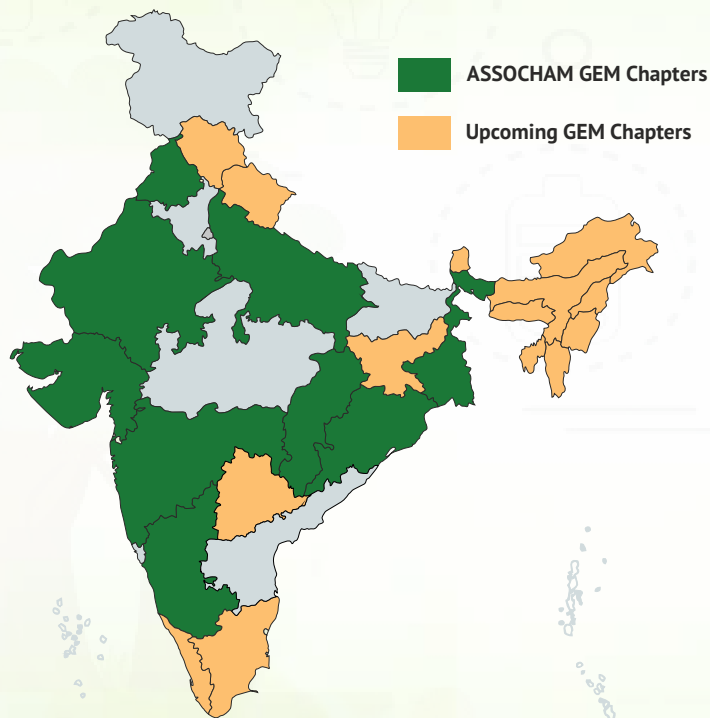

Green Building Rating Agencies

India housing sector is witnessing a paradigm shift towards green and environment friendly buildings.

Green Building Rating Agencies in India



India Green Building Council (IGBC)



Green Rating For Integrated Habitat Assessment (GRIHA)



US Green Building Council



Excellence In Design For Greater Efficiencies



GEM Sustainability (Green) Certification Program



Green building rating system is a tool that evaluates the performance of a building and its impact on the environment.



It comprises of pre-defined set of criteria relating to the entire life cycle of building and facilitates the effective use of site resources, water conservation, energy efficiency, waste management, optimum material utilization and improve indoor environment quality

Proud to have MoUs with



Associated with 80+ Universities and Institutions Across the Nation

MoUs Signed with



GEM Certified Projects



Principal Partner



Platinum Partner



Gold Partners



Silver Partners



Dinner Partner



Water Partner



Kit & Lanyard Partner



Partners



Logo Support



Supporting Associations 2021



Previous Partners & Supporting Associations





GEM 4TH INTERNATIONAL SUSTAINABILITY CONCLAVE, EXPO & AWARDS 2021

30th November to 2nd December 2021 (Virtual)

&

3rd - 4th December 2021, India Habitat Centre, New Delhi*



Please Contact for Further Details

Coordinators

Rajnish Aggarwal

Chair, GEM Events and Expo Committee
Partner, PDA Consultants, New Delhi

Money Khanna

Co-Chair, GEM Events and Expo Committee
Executive Member, GEM Punjab Chapter

Neeraj Arora

Senior Director & Head
GEM Green Building Certification Program

Amit Kumar Sharma

amitkumar.sharma@assochem.com
+91-93527 13762

Shubhabrata Rath

shubhabrata.rath@assochem.com
+91-62898 50187

Tarun Sachdeva

tarun.sachdeva@assochem.com
+91-82390 65445

Deepak Joshi

deepak.joshi@assochem.com
+91-9910361296

Rohit Bhasin

rohit.bhasin@assochem.com
+91-78387 01858

ASSOCHAM Corporate Office

4th Floor, YMCA Cultural Centre and Library Building, 01, Jai Singh Road, New Delhi - 110001
www.assochem.org/gemconclave2021 • www.green-assochem.com