

# International Residence for Researchers

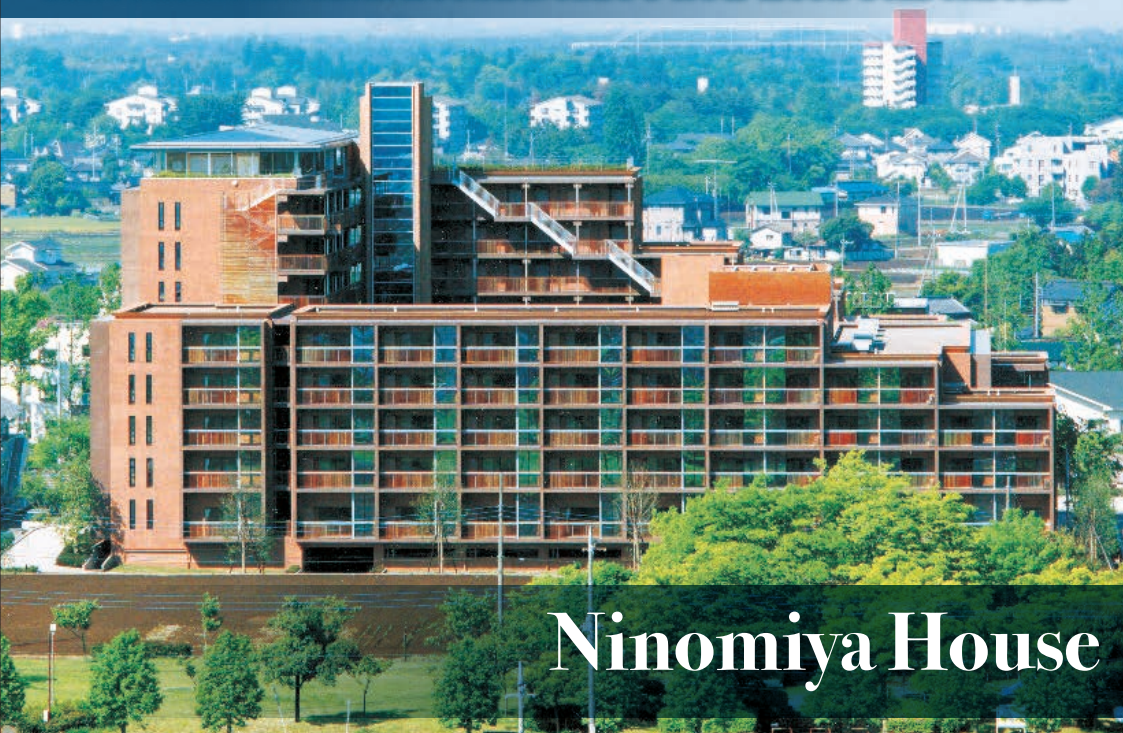

## Ninomiya House

### for one person (34m<sup>2</sup>)

1LK(1 bedroom, living, kitchen)

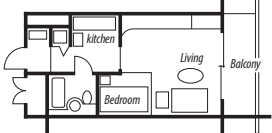

Number of apartments  
175 / 1-8F

for one person 104  
for two persons 71

Furnished

### for two persons (63m<sup>2</sup>)

1LDK(1 bedroom, living/dining, kitchen)

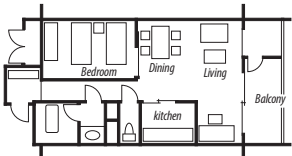

### Common space

- Salon 9F
- Japanese style room/  
Tea ceremony room 9F

- Lounge 3-8F
- Information library 2F
- Assembly hall with kitchen 1F

- Seminar room 1F
- Guest room 1F
- Exercise room 1F

- Children's playroom 1F
- Parking lot (148 spaces)
- Bicycle parking area

### Conditions of Occupancy

- ① Foreign researchers engaging in research activities at public research institutes, universities, as well as private companies.
- ② The period of occupancy is from 15 days to 5 years.

### Rent

for one person : 76,000yen/month  
for two persons : 100,000yen/month

- ① Utilities, telephone and community facility fees are not included.
- ② Neither key money nor deposit is required.
- ③ For a stay of less than 30 days, consumption tax will be imposed.
- ④ Monthly rent will be prorated based on check-in and check-out date.
- ⑤ The user or the research institution they belong to will be responsible for the room cleaning arrangement and the cost when moving out.

### How to apply

Host researchers that accept foreign researchers should make a pre-reservation by telephone or contact form on our website, and then submit the designated application forms to Ninomiya House administration office more than one month in advance.

### Contact

## Japan International Science and Technology Exchange Center (JISTEC)

TEL:+81-29-858-7001

FAX:+81-29-858-7011

URL:<http://www.jst.go.jp/inter/jsthouse/>

E-mail:nino\_take@jistec.or.jp

## Japan Science and Technology Agency International Residence for Researchers NINOMIYA HOUSE

1-6-2 Ninomiya, Tsukuba, Ibaraki 305-0051

TEL:+81-29-858-7000



### ACCESS

- **Tsukuba Express (TX):** Get off at 'Tsukuba' Station.

Take a bus from Tsukuba Center

Destination: No.30, No.31, Hitachi-no-Ushiku Station

Get off: Ninomiya 3-chome (5 min. walk from bus stop)

- **Highway Bus:**

**From Tokyo Station Yaesu South Exit:**

Destination: Tsukuba Center

Get off: Tsukuba Center (Take a taxi or a local bus to Ninomiya House)

**From Narita Airport:**

Destination: Tsukuba Center/Tsuchiura Station

Get off: Tsukuba Center (Take a taxi or a local bus to Ninomiya House)

- **By car:**

Exit 'Tsukuba-Ushiku I.C.' on Ken-o Expressway and proceed to Tsukuba Science City - Gakuen Nishi Odori - Minami Odori



Ninomiya House Courtyard